

## EP3000 Series Pure Sine Wave Inverter

### Feature:

- 35A ~70A automatic 3-stage battery charger
- Charge current is Adjustable(25% ,50% ,75%, 100%),
- Inbuilt pure copper transformer
- Low battery, overload, and high battery, over temperature protection
- Battery/AC priority(option)
- RS232/Remote switch(option)
- Generator compatible

### Back Panel



### Introduction:

Low frequency pure sine wave combined inverter & charger EP3000 Series 1-6kw:Quiet, high efficiency operation Front panel LED/LCD indicators and adjustable switch selectors Selectable settings for flooded lead acid, gel, absorbed glass mat (AGM) batteries.Main for home and office Appliance such as TV,refrigerator,fan,lights,computer etc.

### LCD Display Information

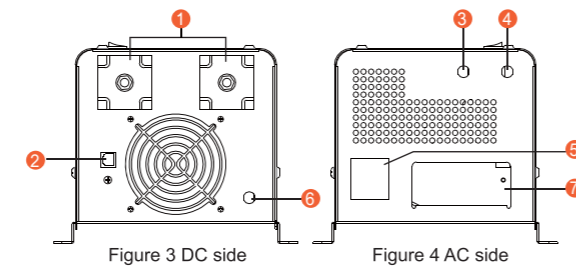
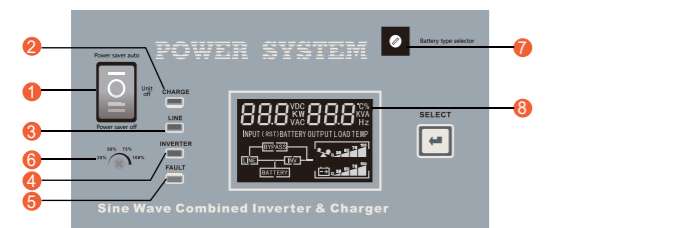

1. Switch	Power saver auto: Power on with saver mode(power saver ≅ 25W) Unit Off: Power totally off(If there is AC power,inverter have charger function) Power saver off: Power on without saver mode
-----------	---

- 2. AC charge
- 3. AC power on
- 4. inverter mode
- 5. Fault
- 6. Charge current adjustable:25%,50%,75%,100%.(Optional)
- 7. Battery type selector
- 8. LCD display

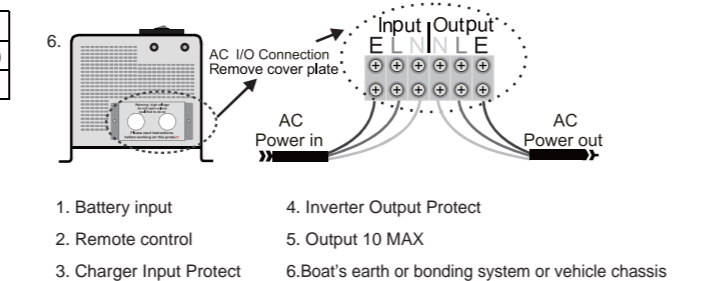

- 1. Battery input
- 2. Remote control
- 3. Charger Input Protect
- 4. Inverter Output Protect
- 5. Output 10 MAX
- 6.Boat's earth or bonding system or vehicle chassis

### Inverter Connection

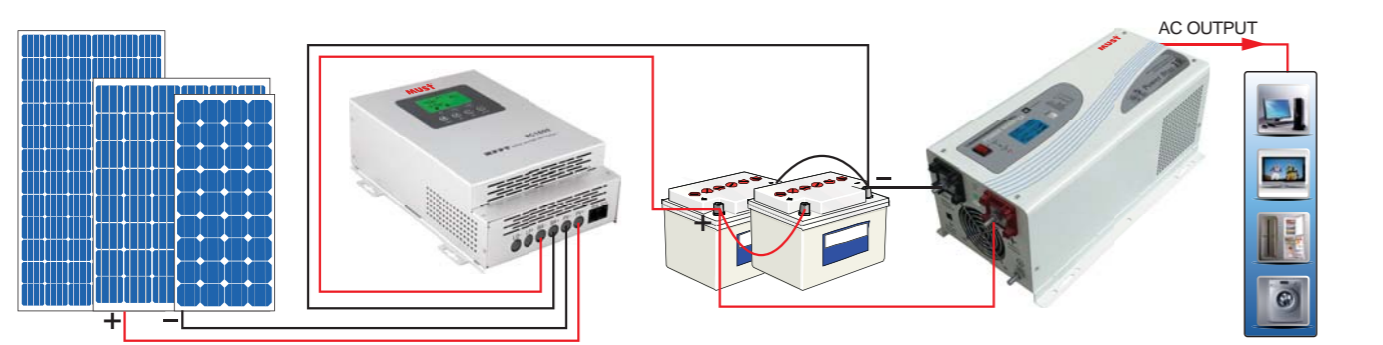

### Specification

MODEL	EP30-1KW	EP30-1.5KW	EP30-2KW	EP30-3KW	EP30-4KW	EP30-5KW	EP30-6KW									
<b>Default Battery System Voltage</b>																
	12V   24V	12V   24V	12V   24V	12V   24V   48V	24V   48V	24V   48V	24V   48V									
<b>INVERTER OUTPUT</b>	Rated Power	1000W	1500W	2000W	3000W	4000W	6000W									
	Surge Rating (20ms)	3000VA	4500VA	6000VA	9000VA	12000VA	18000VA									
	Capable Of Starting Electric Motor	1HP		2HP		3HP										
	Waveform	Pure sine wave/ same as input (bypass mode)														
	Nominal Output Voltage RMS	100V/110V/120VAC or 220V/230V/240VAC					220V/230V/240VAC									
	Output Voltage Regulation	+/-10% RMS														
	Output Frequency	50Hz/60Hz +/-0.3 Hz														
	Inverter Efficiency(Peak)	>88%														
	Line Mode Efficiency	>95%														
	Power Factor	1.0														
Typical Transfer Time	10ms(max)															
<b>AC INPUT</b>	Voltage	120VAC/230VAC														
	Selectable Voltage Range	96~132VAC or 155~280VAC(For Personal Computers)					155~280VAC(For Computers)									
	Frequency Range	50Hz/60Hz (Auto sensing) 40-80Hz														
<b>BATTERY</b>	Minimum Start Voltage	10.0VDC /10.5VDC for12VDC mode (*2 for 24VDC, *4 for 48VDC)														
	Low Battery Alarm	10.5VDC+/-0.3V for12VDC mode (*2 for 24VDC, *4 for 48VDC)														
	Low Battery Cutoff	10.0VDC+/-0.3V for12VDC mode (*2 for 24VDC, *4 for 48VDC)														
	High Voltage Alarm	16.0VDC+/-0.3V for12VDC mode (*2 for 24VDC, *4 for 48VDC)														
	High Battery Voltage Recover	15.5VDC+/-0.3V for12VDC mode (*2 for 24VDC, *4 for 48VDC)														
	Idle Consumption-Search Mode	<25W when power saver on														
<b>CHARGER</b>	Output Voltage	Depends on battery type														
	Charger AC Input Breaker Rating	10A		30A			40A									
	Overcharge Protection S.D.	15.7VDC for 12VDC mode (*2 for 24VDC, *4 for 48VDC)														
	Maximum Charge Current	35A	20A	45A	25A	65A	35A	75A	45A	30A	65A	35A	70A	40A	75A	50A
<b>BYPASS &amp; PROTECTION</b>	Input Voltage Waveform	Sine wave (grid or generator)														
	Nominal Input Frequency	50Hz or 60Hz														
	Overload Protection (SMPS Load)	Circuit breaker														
	Output Short Circuit Protection	Circuit breaker														
	Bypass Breaker Rating	10A		30A			40A									
	Max Bypass Current	10Amp		30Amp			40Amp									
<b>MECHANICAL SPECIFICATIONS</b>	Mounting	Wall mount														
	Dimensions (W*H*D)	423*224*180					597*224*181									
	Net Weight (kg)	15.7	18	16.2	15.5	20.3	19.1	25.3	23.7	24	37.2	34.8	44.15	44	44.15	44
	Shipping Dimensions(W*H*D)	570*315*300					755*319*288									
	Shipping Weight (kg)	18.3	20.6	19	18.1	23.1	21.8	28.1	26.5	26.5	40.8	38.4	48	47.8	48	47.8
<b>OTHER</b>	Operation Temperature Range	0°C to 40°C														
	Storage Temperature	-15°C to 60°C														
	Audible Noise	60dB MAX														
	Display	LED+LCD														
	Loading(20GP/40GP/40HQ)	450pcs / 850pcs / 1000pcs					300pcs / 650pcs / 800pcs									

\* Product specifications are subject to change without further notice.

### Approximate Back-up Time Table

Power Rate(w)	backup time(H) @1*100Ah	backup time(H) @2*100Ah	backup time(H) @4*100Ah	backup time(H) @4*200Ah	backup time(H) @8*200Ah
1000	0.4806	1.602	3.50304	7.6896	
2000	0.2136	0.4806	1.602	3.50304	7.6896
3000	0.1068	0.2848	0.8544	2.136	4.8416
4000		0.2136	0.4806	1.602	3.50304
5000		0.12816	0.34176	1.19616	2.73408
6000		0.1068	0.2848	0.8544	2.136